



PENTAIR

FLECK

CONTROL VALVES

A BRAND WITH HISTORY

WATER PURIFICATION

VALVES - FLECK

Fleck valves cover a wide range of application, either softening or filtration, residential, commercial or industrial, hot or cold water.

Over the past decades, Fleck has demonstrated a proven record of performance and reliability year after year.

MORE THAN 60 YEARS OF EXPERIENCE

Fleck Controls, Inc. was founded in the U.S. in 1950. It started to produce brine valves in 1958 and the first water softener valve in 1963. In 1995 Fleck was acquired by Pentair, the world leader in high technology flow control products providing innovative solutions for residential, commercial and industrial applications.



Fleck production site in Pisa, Italy

MANUFACTURING

From the 70s, Fleck valves (except 5800 valve) have been assembled in Europe in order to better serve the European customers. Today, the production is located in our European center of expertise for valves in Pisa, Italy, where Autotrol and SIATA valves were already assembled.

QUALITY

All valves from the Fleck range have been certified by major EU certificates: CE, 206 / 95 / EC low voltage, 2004 / 108 / EC electromagnetic compatibility, ACS and DM174.

On top that, our Pisa plant is ISO 9001: 2015 certified.

INNOVATION FOCUS

A permanent wish of research and innovation in strong and reliable products allowed Fleck to become with Pentair a leading brand with a global recognition.

With approximately 2,5 million of valves produced in Europe since 1975, we continue to be committed to reliable and innovative products' manufacturing. This responsibility comes from the great Fleck legacy which dates back to 60 years ago, but also from Pentair's overall focus "Continuous improvement in order to satisfy customers' expectations".

CUSTOMIZATION

Today with more than 15 models, Fleck product line has the valve that sets you apart: something unique to sell as you target specific customer needs.

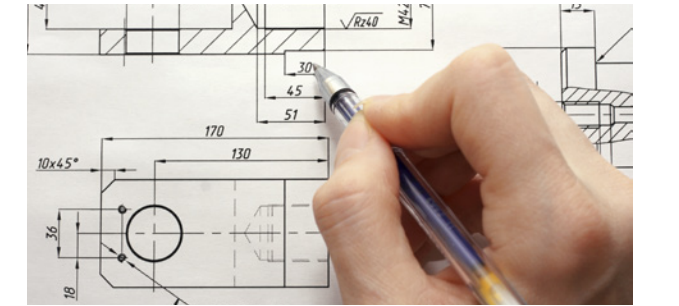

THE COMPLETE RANGE OF FLECK VALVES

	Residential			Commercial				Industrial					
								Mono piston			Bi piston		
	4600	5600 SXT	5800	5810	5812	9000	9100	9500	2750	2850	3150	2910	3900
Valve material	Brass	PPO ¹	PPO ¹	PPO ¹	PPO ¹	Brass	PPO ¹	Brass	Brass	Brass	Brass	Brass	Brass
Inlet/Outlet	¾ or 1 inch	¾ or 1 inch	¾ or 1 inch	1 or 1.25 inch BSP	1 or 1.25 inch BSP	¾ or 1 inch	¾ or 1 inch	1 ½ inch	1 inch	1 ½ inch	2 inches	2 inches	3 inches
Service flow rate (m ³ /h / gpm)	4.5/20	4.5/20	4.7/21	DF/UF/Filter 8,17/36 - 7,9/39 - 7/31	DF/UF/Filter 9,9/43 - 8,9/39 - 8,4/37	4.0/17	4.0/17	8.4/37	5.9/26	11.6/51	22/97	24/105	57/250
Backwash flow rate (m ³ /h / gpm)	1.6/7	1.6/7	3.8/16	DF/UF/Filter 6.3/28 - 6.9/30 - 7.5/33	DF/UF/Filter 7,5/33 - 8,1/36 - 9,9/45	1.9/8	1.9/8	3.3/14	5.6/25	11.1/48	24/105	7.9/35	24/105
Softener tank size	6"-12"	6"-12"	6"-16"	8"-21"	8"-24"	6"-16"	6"-16"	10"-24"	10"-24"	10"-30"	24"-60"	14"-36"	30"-60"
Filter tank size	N/A	N/A	8"-16"	8"-21"	8"-24"	N/A	N/A	N/A	10"-21"	10"-24"	24"-42"	14"-24"	24"-42"
Upflow regeneration		•	•	•	•	•	•	•			•	•	•
Chlorinator			•										
External by-pass	•	•	•	•	•	Eco by-pass	Eco by-pass						
Mixing	•	•	•	•	•		•						
Hot water	•					•		•	•	•	•	•	•
Timer type	Mechanical	SXT	LXT(Storm)/ SXT(Typhoon)/ XTR(Hurricane)	SXT(Typhoon)/ XTR(Hurricane)	SXT(Typhoon)/ XTR(Hurricane)	SXT/ET	SXT/ET	SXT/ET	SXT/NXT	SXT/NXT	NXT	SXT/NXT	NXT
Adjustable cycles		•	SXT/XTR	•	•	•	•	•	•	•	•	•	•
NBP piston									•	•	•	•	•
Manual									•	•	•	•	•
Duplex						Twin	Twin	Twin	•	•	•	•	•
Multiplex									With NXT only	With NXT only	With NXT only	With NXT only	With NXT only

¹PPO: Polyphenylene oxide

BRASS PISTON WITH LOW FRICTION COATING: THE HEART OF FLECK VALVES' PERFORMANCE

Offering an exceptionally broad line of high quality valves for water treatment, Fleck product range ensures that the customer could find the valve needed for his/her specific application.

Basic to the Fleck control's reputation for high quality and performance is a time-tested hydraulically balanced piston, seal and spacer concept to effectively pilot service flow and regeneration.

The only internal moving part is a brass piston with low friction coating.



ADDITIONAL ACCESSORIES

Fleck offers a complete range of accessories, such as distributor systems and air checks, any kind of adapters, yokes and by-passes as well as a selection of safety brine valves.

This selection allows us to create a product configuration, perfectly adapted for each customer specific application, being residential, commercial or industrial.



Safety Brine Valve 2310



Stainless steel by-pass



Plastic yoke

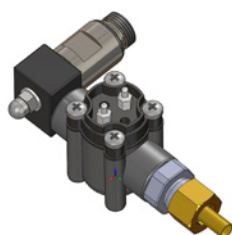

Chlorine cell management



Rotating side mount
adapter for 2850 or 2910



7700 bypass



www.pentairaqueurope.com